

GRIPPEX

Powerful coolant driven bar puller and pick-up unit

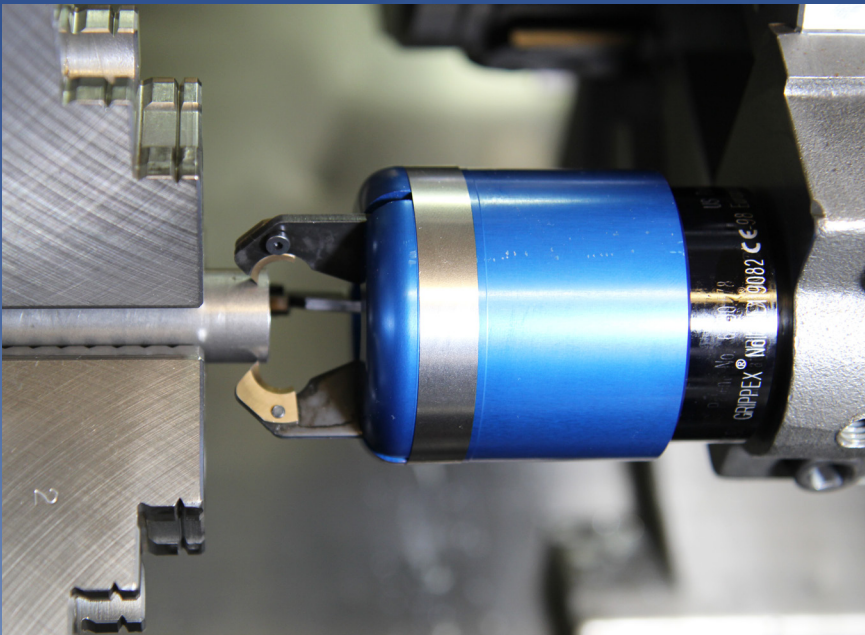

- Instant setup - gripping is secured without any adjustment within the whole gripping range
- Compact and light - Adjacent turret tool positions need not be empty
- Powerful - stands high pressure up to 20 bar
- Grippex doesn't need high pressure for pulling properly. It can work from 0,5 bar onward
- Clamps very close to the chuck, allowing short overhang of the bar
- Clamps hexagon bars without need for spindle orientation
- Can also be used as a pick-up unit with robot jaws

For various reasons, such a high costs or limited floor space in work shops, a small percentage of the CNC lathes are equipped with some kind of magazine-type bar feeder. In small-batch production, however, the machine spindle itself, in addition to its inserted guiding tube and Grippex, provides you with a simple and highly efficient bar feeder.

Grippex is the bar puller that makes your CNC lathe more effective right away!

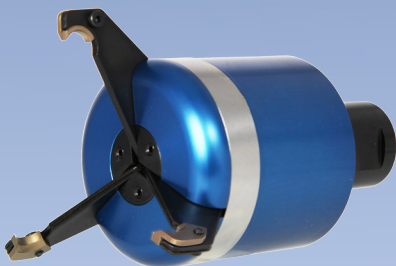

Grippex Large 2-60 mm
3-80 mm
7-105 mm



Grippex Small 2-52 mm

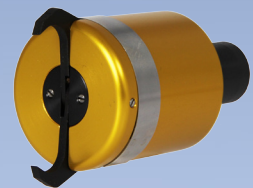

Grippex Mini 0-38 mm
(2 fingers model)

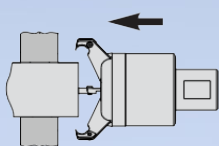

Grippex approaches bar to be pulled

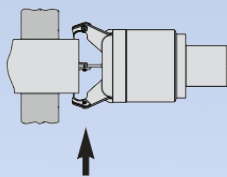

Coolant **ON** for Grippex to clamp

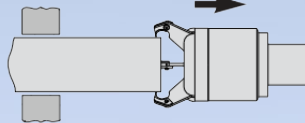

Chuck unclamp, turret moves back along Z-axis and stops exactly at programmed position

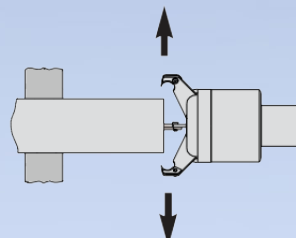

Chuck clamp; coolant **OFF**. Grippex unclamp; turret retracts

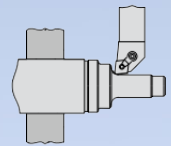

Begin machining new part

Specifications

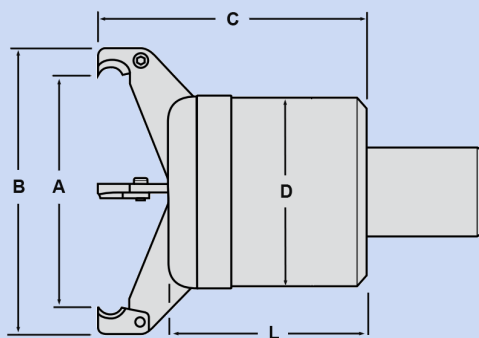

Gripping Range	A	B	C	D	L
Large 2-60 mm	64 mm	83 mm	89 mm	68 mm	71 mm
Large 3-80 mm	83 mm	102 mm	94 mm	68 mm	71 mm
Large 7-105 mm	110 mm	129 mm	108 mm	68 mm	71 mm
Small 2-52 mm	54 mm	74 mm	86 mm	59 mm	64 mm
Mini 0-38 gripping	39 mm	52 mm	61.5 mm	44 mm	49.50 mm
Mini 0-38 robot	40 mm	60 mm	70.5 mm	44 mm	49.50 mm

* VDI 20 for Mini and VDI 30 for Large the length L and C are + 11.80 mm

* VDI 40 for Large the length L and C are + 12.80 mm

Pulling Force Graph

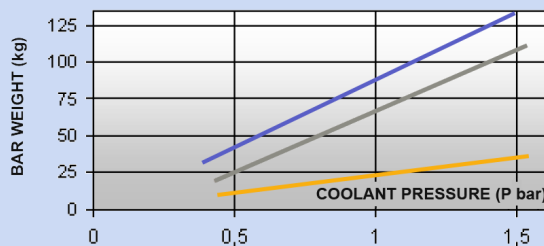

The graph shows the max. allowable weight of a mild steel bar to be pulled at a coefficient of friction valued <0.2

- - Grippex Large max pressure 20 bar
- - Grippex Small max pressure 15 bar
- - Grippex Mini max pressure 7 bar

Grippex Large

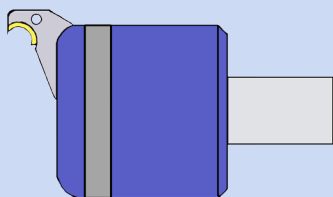

Shanks

- Straight $\varnothing 25$, $\varnothing 32$, $\varnothing 40$ mm
- VDI 30, VDI 40

Gripping fingers

- 2-60 mm
- 3-80 mm
- 7-105 mm

Inserts

- Gripping Inserts (IF)

Option Inserts

- Robot Inserts (RI)
- Robot Jaws (RJ) for 3-80 mm

Grippex Small

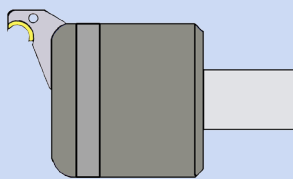

Shanks

- Straight $\varnothing 20$, $\varnothing 25$, $\varnothing 32$ mm
- VDI 20, VDI 30

Gripping fingers

- 2-52 mm

Inserts

- Gripping Inserts (IF)

Option Inserts

- Robot Inserts (RI)

Grippex Mini

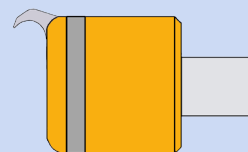

Shanks

- Straight $\varnothing 16$, $\varnothing 20$, $\varnothing 25$ mm
- VDI 16, VDI 20

Gripping fingers

- 0-38 mm (with gripping fingers)
- 0-38 mm (with robot fingers)

Option Inserts

- Robot Jaws (RJ-M) for robot fingers

Distributed by:



Via degli Andreani, 9
40037 Sasso Marconi (BO) ITALY
Tel +39 051 735744
info@tecnimetal-tm.com
www.tecnimetal-tm.com
www.tecnimetal-tm.eu

Grippex® is Patented. Grippex® is a registered trademark by MPC Automation System AB.

The specifications, illustrations, and descriptions in this brochure vary in different markets and are subject to change without notice.

Grippex® IIS - Instructions for disassembling / assembling of fingers

Remark: The new fingers can be mounted using this instruction backwards.

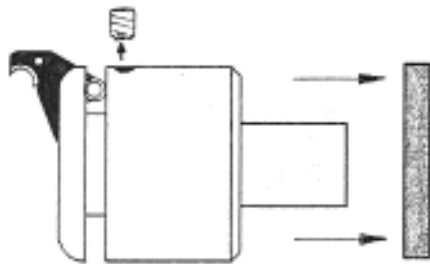

1. Unscrew the Valve-screw and remove the cover.

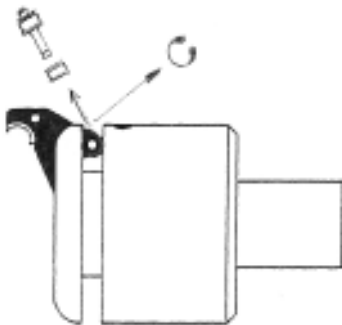

2. Dismount the locking washer on one side of the finger and push the roller pin out of the finger.

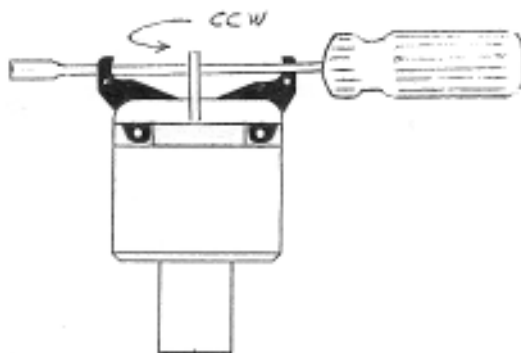

3. Demount the Inserts from the fingers.
Set up Grippex in a vice and clamp on the shank.
Use a screwdriver and turn the body ccw and the body will be loosen from the shank.

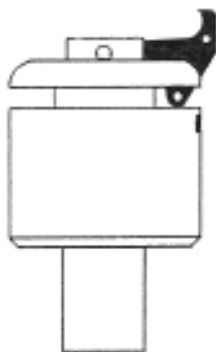

4. Turn the body c.c. approximately 4 turns. Now the three holes (ø4 mm) on the shaft will be visible nearly up to full. Don't turn it too long, otherwise the pins will fall out.
If the shaft doesn't come out automatically, hit the shank a little.

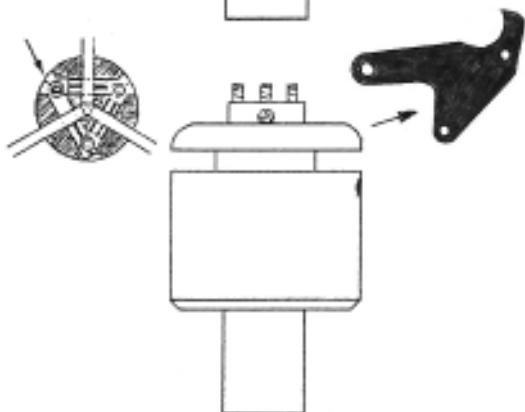

5. Unscrew the three screws (M4x8 mm) on the shank as long as the cylindrical pins can pass and be put aside.
Put the pins aside and the fingers will be released and can be removed.



Via degli Andreani, 9
40037 Sasso Marconi (BO) ITALY
Tel +39 051 735744
info@tecnimetal-tm.com
www.tecnimetal-tm.com
www.tecnimetal-tm.eu



Grippex[®] Mini - Instructions for disassembling / assembling of fingers

Remark: The new fingers can be mounted using this instruction backwards.

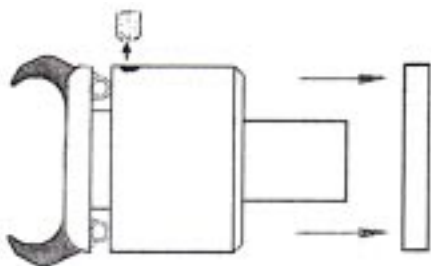

1. Unscrew the Valve-screw and remove the cover.

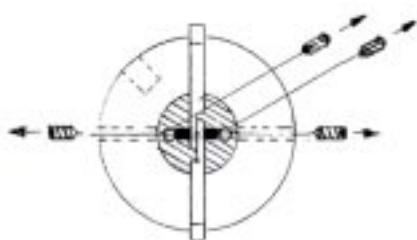

2. Unscrew the two screws on the body and the two stop-screws on the front of the shaft.

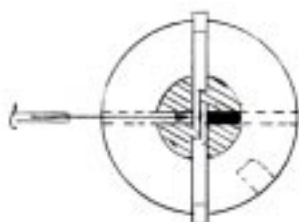

3. Put the pin aside, out of the holes of the fingers.

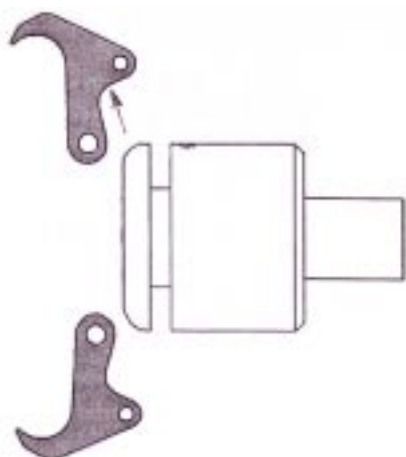

4. The fingers will be released and can be removed.

Notice!

Valve outlet when lathes are equipped with a check valve

An adjustable valve is provided within the body of Grippex, serving machines with a check valve, which prohibits coolant from flowing back when turned off.

In case you want to speed up the release of the fingers, just loosen the screws some turns ccw for quicker release.

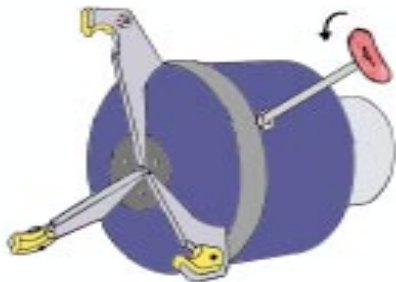

Closed



Open

