

## INSTRUCTIONS FOR USING KATO TANGED COILTHREAD® INSERT TOOLS

THE FOLLOWING INSTRUCTIONS ARE APPLICABLE TO THE  
KATO TANGED REMOVAL/EXTRACTION TOOL (KRTV)

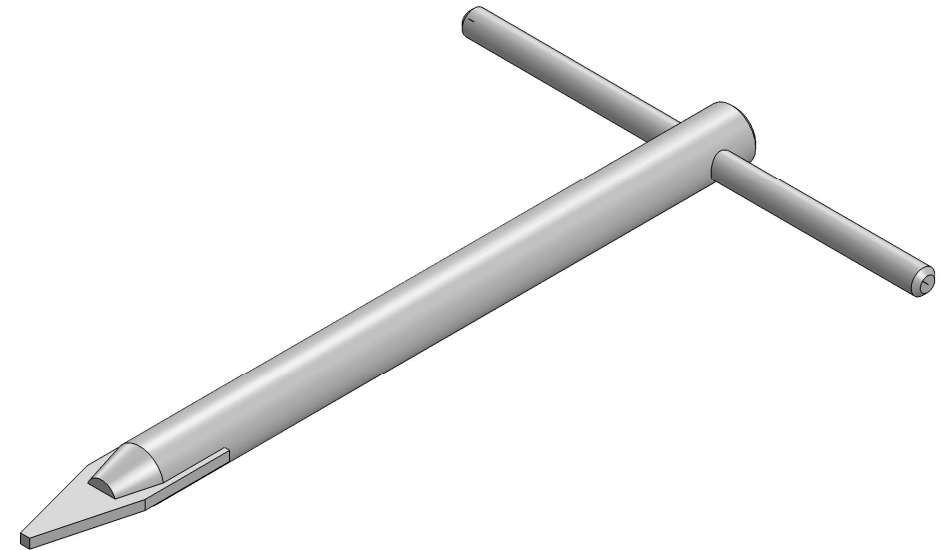

Via degli Andreani, 9  
40037 Sasso Marconi (BO) ITALY  
Tel +39 051 735744  
[info@tecnimetal-tm.com](mailto:info@tecnimetal-tm.com)  
[www.tecnimetal-tm.com](http://www.tecnimetal-tm.com)  
[www.tecnimetal-tm.eu](http://www.tecnimetal-tm.eu)

## BEFORE YOU BEGIN PLEASE REVIEW

- Proper hole preparation procedures.
- Installation depths in accordance with NASM33537.

### INSERT EXTRACTION INSTRUCTIONS

1. Insert the V-Blade of the Extraction Tool into the top of the installed CoilThread insert.
2. Make sure the blade is positioned approximately 90° from the end of the insert to avoid driving the sharp end of the insert outward and into the parent material.
3. Strike the head of the tool lightly with a hammer. This allows the edges of the V-Blade to grip the inside diameter of the insert.
4. Maintain a steady downward pressure on the Extraction Tool handle and turn the tool counterclockwise until the insert is removed.

### NOTE

Contact the KATO Tech-Group for assistance with removing inserts that are installed too deep below the surface.

## TO ELIMINATE THE DIFFICULT & DAMAGING EXTRACTION PROCESS SWITCH TO KATO TANGLESS COILTHREAD INSERTS!

KATO Tangless CoilThread inserts are easy to use and remove. The bi-directional design offers several benefits:

- Reduce installation cycle times since there is no need to orient the insert and no need to break off tangs.
- Less tools needed to complete the installation process.
- FOD-free installation for increased flight safety
- Quick and non-destructive insert removal and depth adjustment.

### TOOL MAINTENANCE

Extraction Tools should be periodically inspected for damage or wear. Operator misuse can contribute to premature wear and/or damage to the tool and/or the parent material.

### PARTS REPLACEMENT

There are no replacement parts for the KATO KRTV series insert Extraction Tool.

### SAFETY

Always wear eye protection when working with KATO tools.

### FOR ASSISTANCE CONTACT THE KATO TECH GROUP AT

Phone: (757) 873-8980

Email: [support@katofastening.com](mailto:support@katofastening.com)

or, visit us online [www.katofastening.com](http://www.katofastening.com)



### TIPS & TRICKS

- If the insert has been installed too deep and the Tang has not been removed, the installation tool can be used to thread the insert through the tapped hole and out the other end (thru holes only).
- Switch to KATO Tangless inserts, and prevent damage to your parts!